

DG BluePRO

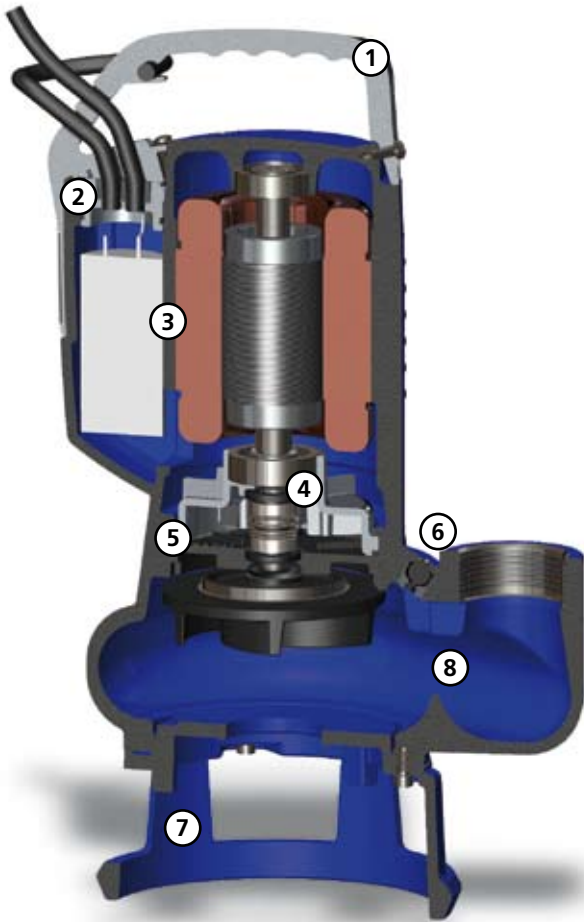

Lifting handle

Ergonomic aluminium alloy lifting and carrying handle, coated for excellent mechanical strength and corrosion resistance. Clip floatswitch adjustment.



Cable gland System

Innovative cable gland system with twin O-rings to ensure maximum tightness

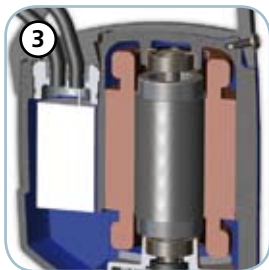

Motor and electrical accessories

Dry motor with thermal protections. Single-phase models with internal capacitor. Three-phase models with motor protection relay (option)



Mechanical seals

Two silicon carbide mechanical seals (2SiC)



Oil sump

Oil sump which guarantees longer mechanical seal lifetime, and is easily accessible thanks to a patented system to simplify maintenance procedures

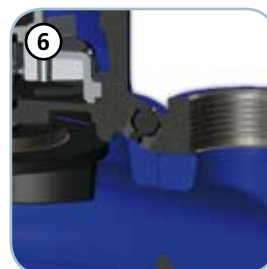

Breather

Breather which allows the air to be vented and ensure reliable pump priming even after long periods out of use



Support foot

Reinforced technopolymer support foot with stainless steel plate (models 50, 75 and 100) or cast iron support foot (models 150 and 200)

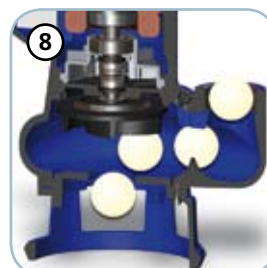

Free passage

Full free passage allowing the expulsion of solids and preventing fouling of the impeller

DG BluePRO

Models with vertical GAS 1 1/2" threaded delivery port - 2 poles

Performances

| | | | | | | | | |
|-------------------|---|-----|-----|------|------|------|------|------|
| l/s | 0 | 1 | 2 | 3 | 4 | 5 | 6 | 7 |
| l/min | 0 | 60 | 120 | 180 | 240 | 300 | 360 | 420 |
| m ³ /h | 0 | 3.6 | 7.2 | 10.8 | 14.4 | 18.0 | 21.6 | 25.2 |

| | | | | | | | | |
|------------------------------------|------|------|-----|-----|-----|-----|-----|-----|
| ① DG BluePRO 50/2/G40V A1BM(T)/50 | 7.0 | 6.0 | 4.9 | 3.6 | 2.4 | 1.1 | | |
| ② DG BluePRO 75/2/G40V A1BM(T)/50 | 10.2 | 9.1 | 8.0 | 6.8 | 5.5 | 4.1 | 2.6 | |
| ③ DG BluePRO 100/2/G40V A1BM(T)/50 | 11.4 | 10.7 | 9.8 | 8.7 | 7.4 | 5.9 | 4.4 | 2.7 |

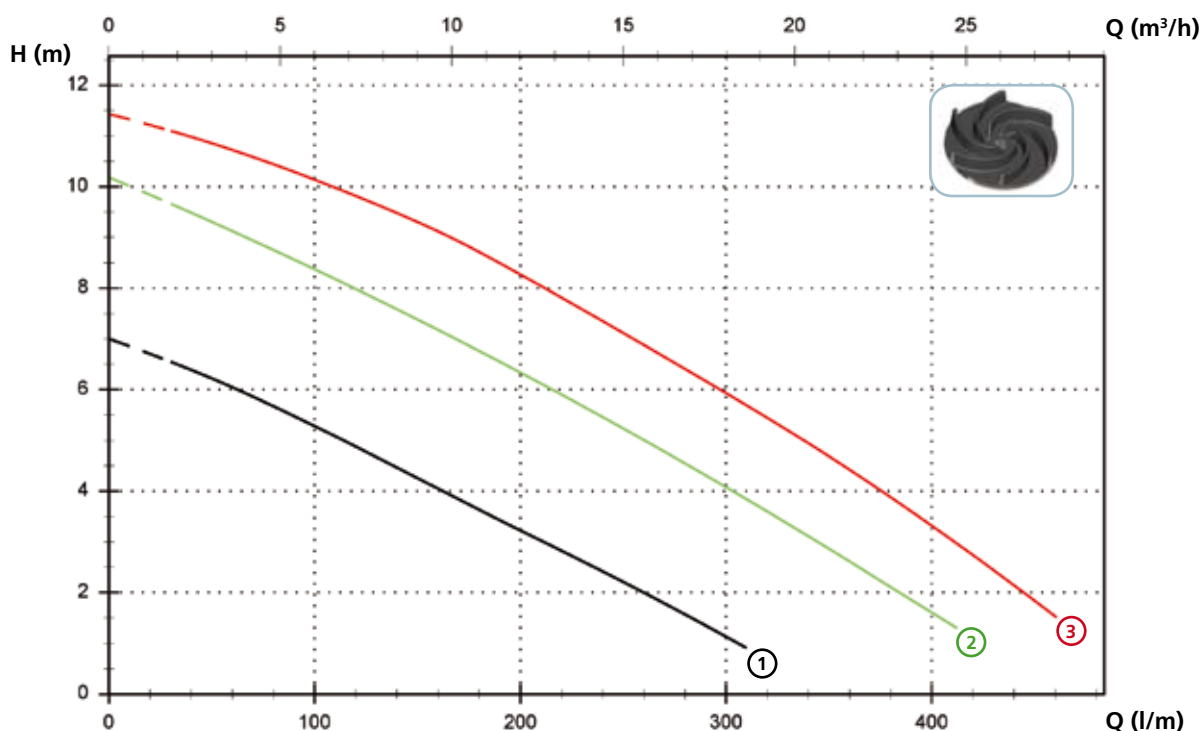

Technical data

| | V | Phases | P1 (kW) | P2 (kW) | A | Rpm | Start | Ø | Cable (*) | Free passage |
|---------------------------------|-----|--------|---------|---------|-----|------|-------|----------|-----------|--------------|
| ① DG BluePRO 50/2/G40V A1BM/50 | 230 | 1 | - | 0.37 | 2.8 | 2900 | Dir | G 1 1/2" | A | 40 mm |
| ② DG BluePRO 75/2/G40V A1BM/50 | 230 | 1 | - | 0.55 | 4.1 | 2900 | Dir | G 1 1/2" | A | 40 mm |
| ③ DG BluePRO 100/2/G40V A1BM/50 | 230 | 1 | - | 0.74 | 5.6 | 2900 | Dir | G 1 1/2" | A | 40 mm |

| | V | Phases | P1 (kW) | P2 (kW) | A | Rpm | Start | Ø | Cable (*) | Free passage |
|---------------------------------|-----|--------|---------|---------|------|------|-------|----------|-----------|--------------|
| ① DG BluePRO 50/2/G40V A1BT/50 | 400 | 3 | - | 0.37 | 1.15 | 2900 | Dir | G 1 1/2" | B | 40 mm |
| ② DG BluePRO 75/2/G40V A1BT/50 | 400 | 3 | - | 0.55 | 1.6 | 2900 | Dir | G 1 1/2" | B | 40 mm |
| ③ DG BluePRO 100/2/G40V A1BT/50 | 400 | 3 | - | 0.74 | 2.15 | 2900 | Dir | G 1 1/2" | B | 40 mm |

(*) A = H07RN-F 3G1 - 5 m cable length with schuko plug. Optional 10 m cable length with schuko plug.
 B = H07RN-F 4G1 - 10 m cable length

Attention: Standard EN 60335-2-41 requires the use of a 10 m cable length in outdoor applications

DG BluePRO

Models with vertical GAS 2" threaded delivery port - 2 poles

Performances

| | l/s | 0 | 2 | 4 | 6 | 8 | 10 | 12 |
|------------------------------------|-------------------|------|------|------|------|------|------|------|
| | l/min | 0 | 120 | 240 | 360 | 480 | 600 | 720 |
| | m ³ /h | 0 | 7.2 | 14.4 | 21.6 | 28.8 | 36.0 | 43.2 |
| ① DG BluePRO 150/2/G50V A1CM(T)/50 | | 12.3 | 10.7 | 8.8 | 6.5 | 4.4 | 2.4 | |
| ② DG BluePRO 200/2/G50V A1CM(T)/50 | | 15.3 | 13.7 | 11.7 | 9.4 | 7.1 | 4.7 | 2.5 |

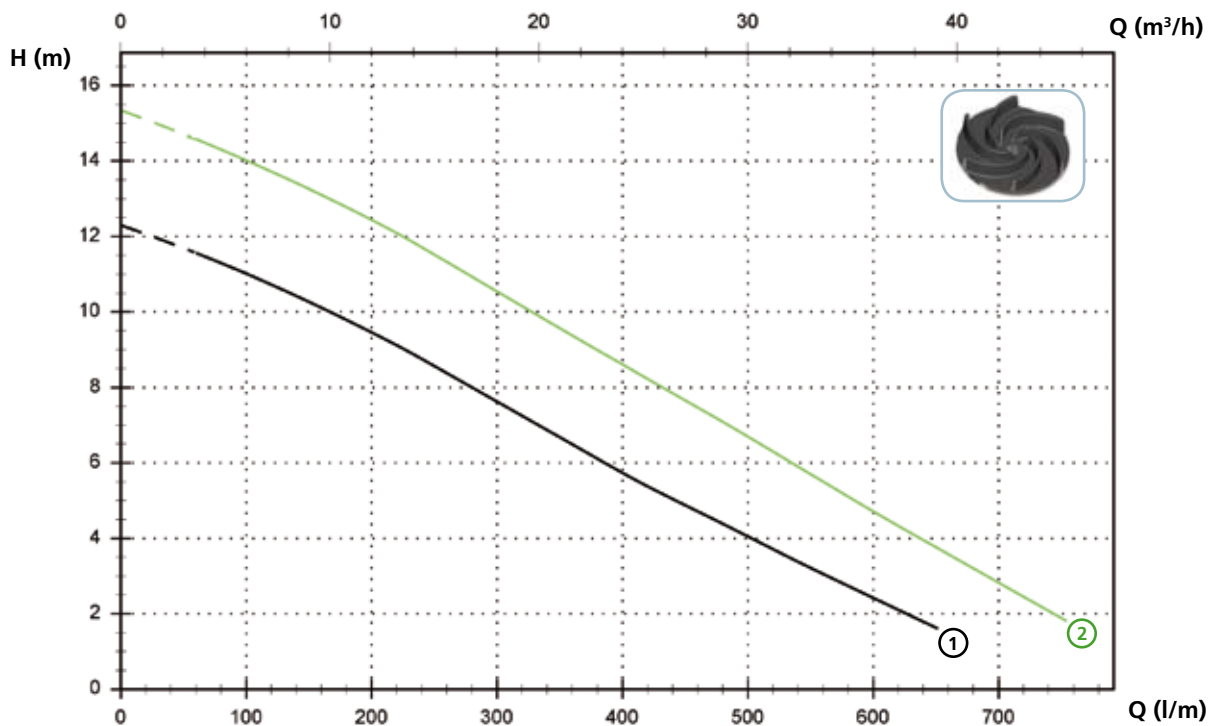

Technical data

| | V | Phases | P1 (kW) | P2 (kW) | A | Rpm | Start | Ø | Cable (*) | Free passage |
|---------------------------------|-----|--------|---------|---------|-----|------|-------|------|-----------|--------------|
| ① DG BluePRO 150/2/G50V A1CM/50 | 230 | 1 | - | 1.1 | 7.5 | 2900 | Dir | G 2" | A | 50 mm |
| ② DG BluePRO 200/2/G50V A1CM/50 | 230 | 1 | - | 1.5 | 10 | 2900 | Dir | G 2" | A | 50 mm |

| | V | Phases | P1 (kW) | P2 (kW) | A | Rpm | Start | Ø | Cable (*) | Free passage |
|---------------------------------|-----|--------|---------|---------|-----|------|-------|------|-----------|--------------|
| ① DG BluePRO 150/2/G50V A1CT/50 | 400 | 3 | - | 1.1 | 3.2 | 2900 | Dir | G 2" | B | 50 mm |
| ② DG BluePRO 200/2/G50V A1CT/50 | 400 | 3 | - | 1.5 | 4.3 | 2900 | Dir | G 2" | B | 50 mm |

(*) A = H07RN-F 3G1 - 5 m cable length with schuko plug. Optional 10 m cable length with schuko plug.
 B = H07RN-F 4G1 - 10 m cable length

Attention: Standard EN 60335-2-41 requires the use of a 10 m length cable in outdoor applications

DG BluePRO

Versions available

(Key to versions on page 16)

| | Electrical variants | | | | | | | | | | | Cooling | | | | Mechanical seals | | | | |
|-------------------------------|---------------------|---|--------|-------------|------------------|-----------------------|-------------|------------------|-----------------------|--------|--------|-------------|---|-----------|----|------------------|------|------|-------|--------|
| | N A E | T | T C | T C D | T C D T | T C D G T | T C G | T C S T | T C S G T | T S | T R | T R G | N | CC CCE | FT | C G F T | 2SIC | SICM | SICAL | 2SICAL |
| DG BluePRO 50/2/G40V A1BM/50 | | | ● | | | | ● | | | | | | ● | | | | ● | | | |
| DG BluePRO 75/2/G40V A1BM/50 | | | ● | | | | ● | | | | | | ● | | | | ● | | | |
| DG BluePRO 100/2/G40V A1BM/50 | | | ● | | | | ● | | | | | | ● | | | | ● | | | |
| DG BluePRO 150/2/G50V A1CM/50 | | | ● | | | | ● | | | | | | ● | | | | ● | | | |
| DG BluePRO 200/2/G50V A1CM/50 | | | ● | | | | ● | | | | | | ● | | | | ● | | | |
| DG BluePRO 50/2/G40V A1BT/50 | ● | | | | | | | | | | | ● | ● | | | | ● | | | |
| DG BluePRO 75/2/G40V A1BT/50 | ● | | | | | | | | | | | ● | ● | | | | ● | | | |
| DG BluePRO 100/2/G40V A1BT/50 | ● | | | | | | | | | | | ● | ● | | | | ● | | | |
| DG BluePRO 150/2/G50V A1CT/50 | ● | | | | | | | | | | | ● | ● | | | | ● | | | |
| DG BluePRO 200/2/G50V A1CT/50 | ● | | | | | | | | | | | ● | ● | | | | ● | | | |

Overall dimensions and weights

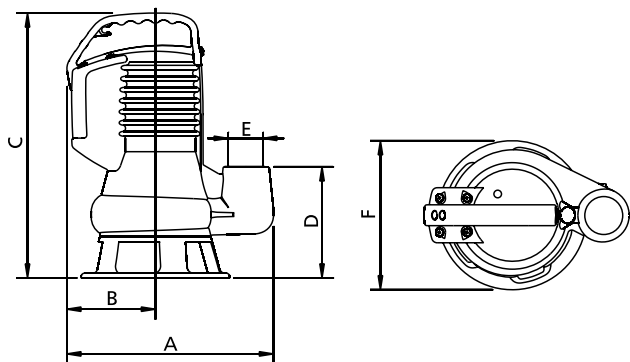

| | A | B | C | D | E | F | kg |
|----------------------------------|-----|-----|-----|-----|----------|-----|------|
| DG BluePRO 50/2/G40V A1BM(T)/50 | 265 | 115 | 335 | 140 | G 1 1/2" | 190 | 13 |
| DG BluePRO 75/2/G40V A1BM(T)/50 | 265 | 115 | 335 | 140 | G 1 1/2" | 190 | 15 |
| DG BluePRO 100/2/G40V A1BM(T)/50 | 265 | 115 | 335 | 140 | G 1 1/2" | 190 | 15.5 |

Measurements in mm

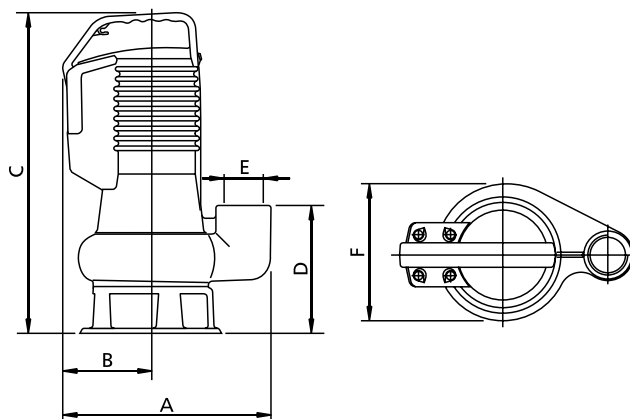

| | A | B | C | D | E | F | kg |
|----------------------------------|-----|-----|-----|-----|------|-----|----|
| DG BluePRO 150/2/G50V A1CM(T)/50 | 295 | 125 | 465 | 195 | G 2" | 200 | 23 |
| DG BluePRO 200/2/G50V A1CM(T)/50 | 295 | 125 | 465 | 195 | G 2" | 200 | 24 |

Measurements in mm